



St Andrew the Apostle

Greek Orthodox School



6 September 2023

Dear Parents/Carers,

Dropping off and picking up students from St Andrew the Apostle School

You may have seen the progress on the construction of our new school building and I wanted to update you about arrangements for dropping off and picking up students from St Andrew the Apostle School from the start of term on 6 September 2023.

Thank you for your patience with closure of the Brunswick Park Road entrance last year. The entrance will continue to be closed to traffic for the duration of the building of our new site; however, we are pleased to inform you that there will be pedestrian access for students via Brunswick Road from 6 September 2023. Our construction company (B&K) has created a pathway from the Brunswick Road to Building 5, which will aid access to students who live on the Brunswick Road side of the school for the days that they are timetabled in Building 5.

Please note the following regarding the use of this entrance:

- It is exclusively for students, and parents must drop-off at the start of the pathway.
- Parents who have appointments at the school must enter via Oakleigh Road so that they can enter through the visitors' entrance and sign in at reception.
- Entrance to the pathway will be open from 8.00am to 8.25am and from 3.00pm to 3.25pm. These times will be strictly adhered to.
- Students who are timetabled in Building 4 must enter the North London Business Park through the Oakleigh Road entrance.

All other arrangements for dropping off students by car will continue. Therefore, if you wish to drop your child off at school, please access the North London Business Park via Oakleigh Road, continuing around the multi-storey car park and dropping off in the bays in front of the multi-storey car park. Please see overleaf for a map of our site, which indicates the drop off route for cars in green. If you are collecting students at the end of the day, you may park in white bays on the ground floor of the car park, but please do not arrive before 2.45pm and ensure you leave before 3.20pm.

To reduce your travel time and to lessen traffic to make the roads near our school safer (and with a view on working towards goals in the travel plan for our new school building), please look at alternatives to dropping off your children on the school site, which is served well by a number of different bus routes. You may also wish to use 'ride and stride', dropping off your child a couple of roads away from site such that they can walk the remainder of the way to school.

We will review the usage of these entrances in the opening weeks of the school term. If you have any questions or suggestions regarding the changes mentioned above, please contact the school through the usual channels.

Yours sincerely,

Dr Philip Hills
Headteacher



St Andrew the Apostle

Greek Orthodox School

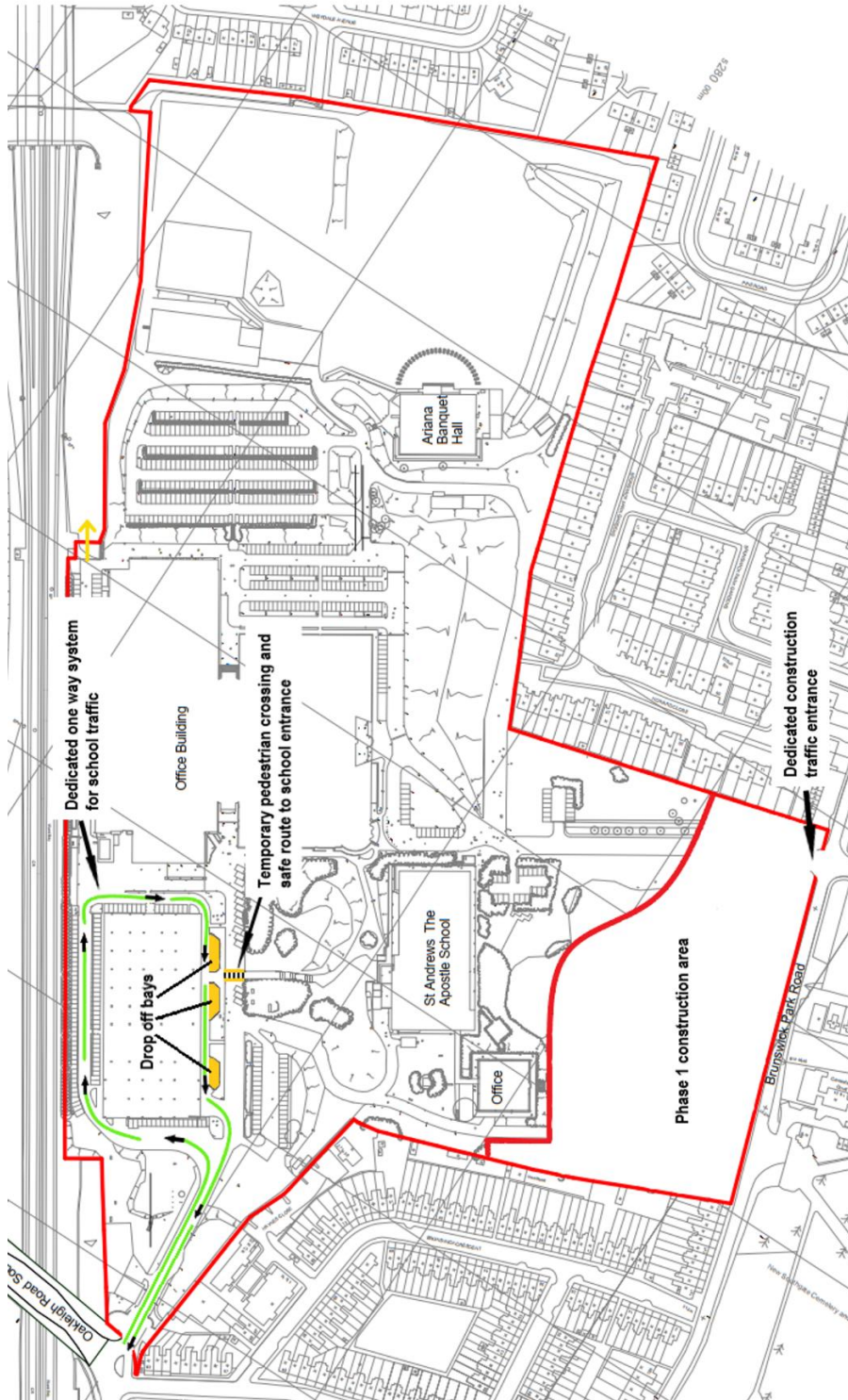

St Andrew the Apostle Greek Orthodox School, Building 5, North London Business Park, Oakleigh Road South, London, N11 1BF Telephone Number: 020 3195 5444

Email: admin@standrewtheapostle.org.uk, Website: www.standrewtheapostle.org.uk

